



*Conference for*  
**Agricultural  
Worker Health**

National Association of Community Health Centers



**May 2-4, 2023 | Grand Hyatt Seattle - Seattle, WA**

***Sowing Strength/Cultivando Fortaleza:  
Meeting Environmental, Social, and Care Challenges  
in Farmworker Health***



NATIONAL ASSOCIATION OF  
Community Health Centers®



# WE ARE STRONGER TOGETHER

Join Today! Mention this ad to receive 20% off your first-year Organizational Membership Dues!

Become a member of the National Association of Community Health Centers (NACHC) and stand with thousands of your health center colleagues to strengthen, preserve, and expand the health center mission. Membership is open to health centers, dedicated professionals, non-profits, corporations and students.

“

NACHC is the only national organization dedicated solely to CHCs and the people we serve. Their leadership in preserving patient-centered boards, securing federal funding to care for the uninsured, and advocating for COVID-19 resources, are just a few of the reasons I am grateful for NACHC's work.

**- Dr. Simon Hambidge, CEO, Denver Health's Community Health Services, NACHC MEMBER**



***Sowing Strength/Cultivando Fortaleza:  
Meeting Environmental, Social, and Care Challenges in Farmworker Health***

**Table of Contents**

**NACHC Board of Directors** ..... 2

**Welcome** ..... 3

**General Information** ..... 5

    Accessing Conference Handouts ..... 5

    Wi-Fi ..... 5

    Mobile App ..... 6

    Registration and Speaker/Sponsor Check-In ..... 6

    Conference Hotel ..... 6

**Conference Basics** ..... 8

**Music Playlist/Liner Notes for Conference** ..... 9

**Program Events** ..... 11

**Key to Moderators and Presenters** ..... 30

**Ad Index** ..... 31

**Sponsor Profiles** ..... 33

**Upcoming NACHC Conferences and Trainings** ..... 40

**Hotel Diagram** ..... Inside Back Cover

# 2023-2024 NACHC Board of Directors

## EXECUTIVE COMMITTEE



*Chair of the Board*  
**Michael A. Holmes**  
*Scenic Rivers Health Services*  
*Cook, MN*



*Chair-Elect*  
**Paloma Hernandez**  
*Urban Health Plan, Inc.*  
*Bronx, NY*



*Immediate Past Chair*  
**Lathran J. Woodard**  
*South Carolina Primary Health*  
*Care Association*  
*Columbia, SC*



*Speaker of the House*  
**Henry Taylor, MPA**  
*Mile Square Health Center*  
*Chicago, IL*



*Vice-Speaker of the House*  
**Kimberly Chang, MD**  
*Asian Health Services*  
*Oakland, CA*



*Secretary*  
**Sue Veer, MBA**  
*Carolina Health Centers*  
*Greenwood, SC*



*Treasurer*  
**John Santistevan**  
*Salud Family Health Centers*  
*Ft. Lupton, CO*



*Consumer/Board Member*  
*Representative*  
**Virginia "Ginger" Fuata**  
*Waianae Coast*  
*Comprehensive Health Center*  
*Waianae, HI*



*Parliamentarian*  
**Jana Eubank, MPAff**  
*Texas Association of*  
*Community Health Centers*  
*Austin, TX*

## REPRESENTATIVES FROM CHARTERED REGIONS

### REGION I

**Susan Joss**  
*Brockton Neighborhood Health Center*  
*Brockton, MA*

**Michael R. Taylor**  
*Cornell Scott-Hill Health Corporation*  
*New Haven, CT*

### REGION II

**Kemi Alli, MD**  
*Henry J. Austin Health Center*  
*Trenton, NJ*

**Mary Ann Zelazny**  
*Finger Lakes Community Health*  
*Penn Yan, NY*

### REGION III

**Sonya Bruton, PsyD, MBA**  
*CCI Health*  
*Silver Spring, MD*

**Mathew Weimer, MD**  
*Valley Health Systems, Inc.*  
*Huntington, WV*

### REGION IV

**Carla Belcher**  
*Community Health Care Systems, Inc.*  
*Wrightsville, GA*

**Steven Miracle**  
*Georgia Mountains Health Services*  
*Blue Ridge, GA*

### REGION V

**Veronica Clarke**  
*TCA Health*  
*Chicago, IL*

**Beth A. Wrobel**  
*HealthLinc*  
*Valparaiso, IN*

### REGION VI

**William Brent, III**  
*SWLA Center for Health Services*  
*Lake Charles, LA*

**Brook Lattimore**  
*Stigler Health and Wellness Center*  
*Stigler, OK*

### REGION VII

**Jeron L. Ravin, JD**  
*Swope Health Services*  
*Kansas City, MO*

**Aaron Todd**  
*Iowa Primary Care Association*  
*Des Moines, IA*

### REGION VIII

**Keith O. Horwood, MD**  
*Community Health Centers, Inc.*  
*West Valley, UT*

**Lucy W. Loomis, MD, MSPH**  
*Denver Health*  
*Denver, CO*

### REGION IX

**Warren J. Brodine**  
*Eisner Health*  
*Los Angeles, CA*

**Douglas Spegman, MD**  
*El Rio Community Health Center*  
*Tucson, AZ*

### REGION X

**Heidi Hart**  
*Terry Reilly Health Services*  
*Nampa, ID*

**Jennifer Kreidler-Moss**  
*Peninsula Community Health Services*  
*Bremerton, WA*

## NATIONALLY ELECTED REPRESENTATIVES

### CLINICIAN REPRESENTATIVES

**Daniel Miller, MD**  
*Sun River Health*  
*Tarrytown, NY*

**Felix M. Valbuena, Jr., MD**  
*Community Health & Social Service Center*  
*(CHASS)*  
*Detroit, MI*

### HEALTH CENTER BOARD MEMBER REPRESENTATIVES

**Terri Garcia**  
*HealthNet, Inc.*  
*Indianapolis, IN*

**Deborah Woolford**  
*Park West Medical Center*  
*Baltimore, MD*





# Welcome



**Welcome** to Seattle and the 2023 Conference for Agricultural Worker Health of the National Association of Community Health Centers!

We assemble with colleagues and partners to carry forward our mission to improve the health and well-being of Migrant and Seasonal Agricultural Workers. They are the individuals who tend the nation's fields and grow and harvest the crops. They are America's "essential" workers – upon whom the nation depends for its food supplies.

This year our conference theme is: **Sowing Strength/Cultivando Fortaleza: Meeting Environmental, Social, and Care Challenges in Farmworker Health**. During our program, we will give focus to the emerging challenges facing agricultural workers as the nation confronts climate change, as well as the impact of social change and growing anti-immigrant sentiment in this country. In addition, we will take the lessons learned from the pandemic to ensure that we continue to advance equity in the nation's health delivery system.

This is our opportunity to come together to network, learn, and share experiences. The conference will offer robust educational sessions featuring health center practitioners, national subject matter experts, and farmworker health policy advocates. We will also provide an update on the *Ag Worker Access Campaign*. We will assess what we must do further to give collective voice to the pervasive health needs of a vulnerable population and to extend the reach of our programs to the many agricultural worker families throughout our country – who need help.

And as is traditional, a special part of our program will honor those among us who have given dedicated service in Migrant Health and whose leadership has helped move the nation toward a stronger, more equitable health system that respects the dignity, culture, and work of all people.

On behalf of the NACHC Board of Directors and staff, thank you for joining us and your continuing support of this conference. Now, let's get started!

**Rachel A. Gonzales-Hanson**

Interim President and CEO

National Association of Community Health Centers



# CENTENE<sup>®</sup> Corporation

## True Partners in Care

Centene is committed to transforming the health of the communities we serve, one individual at a time. We know that every community faces unique challenges, which is why each of our health plans are managed, staffed, and real time decisions are delivered locally. Through our partnerships with FQHCs, hospitals, and physicians, we offer better solutions for better outcomes at lower costs.

Centene state health plans reflect our core belief that healthcare is best delivered locally.





# General Information

## **Land Acknowledgement**

*We, the Planning Committee and hosts of the 2023 Conference for Agricultural Worker Health, honor and acknowledge that this event is taking place on occupied Coast Salish land, specifically the ancestral land of the Duwamish, Suquamish, Stillaguamish, Muckleshoot, Snoqualmie, and other Indigenous peoples. We recognize the stewardship of these lands and waters by Coast Salish peoples since time immemorial and the disruption of this work by colonization. We acknowledge the painful and persistent legacy of genocide and forced removal from this land and honor the resilience of the Indigenous communities who continue to thrive here. We recognize that this statement becomes meaningful when coupled with sustained commitment, accountable relationship, and informed action. May this acknowledgement serve as a proclamation of our organizations' gratitude to the land and the Coast Salish peoples, and our renewed commitment to equity and social justice.*

## **Accessing Conference Handouts**

All conference presentations and handouts provided by speakers will only be available on the *NACHC Mobile App*. The NACHC Mobile App is only accessible on mobile devices such as a smartphone, tablet, or Kindle. You can download the app by searching for "NACHC Mobile" in either the Apple Store or Google Play Store. If your device does not have access to these stores, the mobile app cannot be installed on your device.

To access presentation materials, evaluations, and speaker bios, download the mobile app (*refer to page 6 for download instructions*); you can do this both during and ahead of the conference. It is your responsibility to download these materials to your electronic device and/or print copies if you prefer to have them available in paper form.

## **Wi-Fi**

Conference attendees will have Wi-Fi access during the 2023 Conference for Agricultural Worker Health. Internet access will be available throughout the conference event spaces. **Simply connect to the NACHC Conference network and enter the password 2023AGWORKER for access.**

Note: NACHC cannot provide end-user support and personal assistance for PC configuration or troubleshooting; and does not screen or restrict access to any content placed on or accessible through the internet.

## **NACHC Conference Code of Conduct**

All attendees, speakers, sponsors, and volunteers at our conference are required to agree with the following code of conduct. NACHC will enforce this code throughout the event. We expect cooperation from all participants to help ensure a safe environment for everyone.

*Our conference is dedicated to providing a harassment-free environment for everyone, regardless of gender, gender identity and expression, age, sexual orientation, disability, physical appearance, body size, race, ethnicity, or religion. We do not tolerate harassment of conference participants in any form. This also includes inappropriate physical contact and unwelcome sexual attention. Sexual language and imagery are not appropriate for any conference event including talks, workshops, social gatherings, and all online social media/networking sites. Participants asked to stop any harassing behavior are expected to comply immediately. Conference participants violating these rules may be sanctioned or expelled from the conference without a refund at the discretion of NACHC.*

**If you are being harassed, notice that someone else is being harassed, or have any other concerns, please contact a member of the conference staff immediately.**



# General Information, continued

## Mobile App

Interact with speakers and colleagues both on-site and online!

### From your mobile device, you can:

- ▶ Complete session evaluations
- ▶ Participate in real-time polls

To access the NACHC MOBILE APP, you will need your iMIS login and password.

### How to locate and download the Mobile App from Google Play Store or Apple:

1. Launch the Google Play Store or App Store
2. Search for **NACHC Mobile**
3. Tap the event app icon/listing
4. Tap Install
5. Enter Google ID or Apple ID password and click OK
6. Tap Accept and Download
7. App will download and display on your phone
8. Tap the NACHC Mobile App
9. Tap the ≡ icon
10. Tap 2023 Conference for Agricultural Worker Health



Scan to download the NACHC Mobile App

Once you have downloaded the app, you **MUST** log in to access presentations.

Note: Adobe Reader **MUST** be installed on your Android device in order to open the presentations.

### Forgot your iMIS login and password?

1. Go to a browser and type in **NACHC.org**
2. On the right side menu, click on **NACHC Account Management**
3. Under Existing Users, click **Forgot Your Password**
4. **Enter your email**

You will immediately receive an email with your iMIS login and password. Still having problems? No worries. Stop by NACHC's Speaker/Sponsor Check-In, in the Leonesa Ballroom Foyer, where staff will be available to assist you.

## Registration

NACHC Registration is in the Leonesa Ballroom Foyer. Registered attendees can pick up their badges and conference materials during the following hours:

### Registration Hours

Monday, May 1	3:00pm – 5:00pm
Tuesday, May 2	7:30am – 12:00pm 1:30pm – 4:00pm
Wednesday, May 3	7:30am – 11:45am 1:30pm – 3:15pm
Thursday, May 4	7:30am – 10:00am

## Speaker Check-In

NACHC's Speaker Check-In is in the Leonesa Ballroom Foyer. All speakers are asked to report to this area upon arrival at the conference. Speakers will receive badges and review or upload presentations at check-in.

**Speaker Check-In hours are the same as registration hours.**

## Sponsor Check-In

NACHC's Sponsor Check-In is in the Leonesa Ballroom Foyer. All sponsors are asked to report to this area upon arrival at the conference. Sponsors can pick up badges and tabletop packets during the following hours:

### Sponsor Check-In Hours

Monday, May 1	1:00pm – 5:00pm (Check-In and Setup)
Tuesday, May 2	7:30am – 12:00pm 1:30pm – 4:00pm
Wednesday, May 3	7:30am – 11:45am 1:30pm – 3:15pm

## Conference Hotel

Grand Hyatt Seattle  
721 Pine Street  
Seattle, WA 98101  
+1 (206) 774-1234

NACHC gratefully acknowledges the following Silver Sponsor:

Lanyards



## Development and Innovation Activity

*What innovation is needed at your health center in service to the farmworker population? We want to hear from you! Using the postcards in your welcome bag or at registration, please tell us about the innovation you would like to see within your organization and deposit it in the collection box located at the NACHC table in the Leonesa Ballroom Foyer. Results will be collected, compiled, and shared with everyone in attendance. Help cultivate the future of innovation!*



# FOR unmatched industry insight, VISion matters

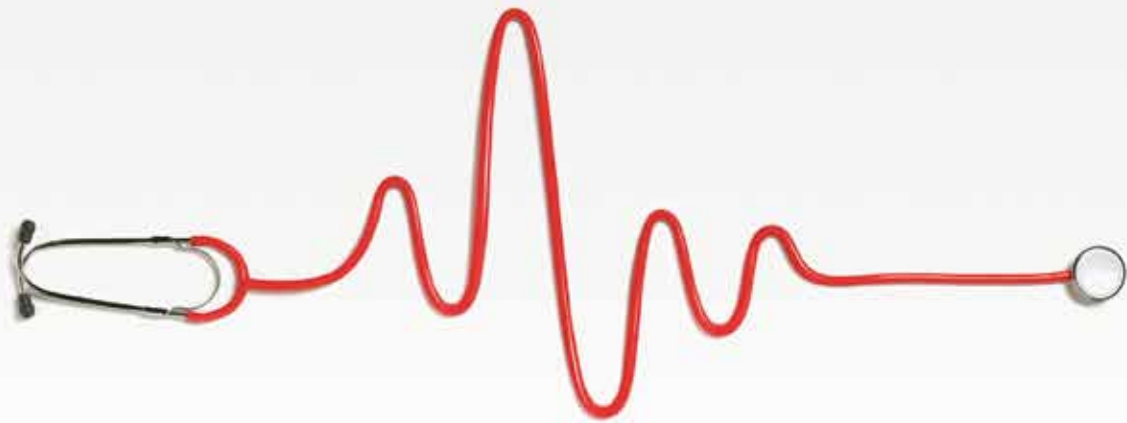

## / FORward VISion revives

We applaud that the lives you mend begin with your vision of making a positive impact in the world. Our vision is helping make yours a reality. Whether you're looking to navigate regulatory compliance, reduce risk, or identify reimbursement opportunities, our forward-thinking professionals can help you prepare for what's next.

**FORVIS**—created by the merger of equals between BKD and DHG—has the enhanced capabilities of an expanded national platform and deepened industry intelligence to help you better navigate the healthcare landscape and bring your hospital's vision to life.

# FORVIS™

ASSURANCE / TAX / ADVISORY



# Conference Basics

## Business Center

The Grand Hyatt Seattle Business Center can serve as your extended office while you are in town. It is located on the Lobby Level (next to Starbucks) and available 24 hours a day/7 days a week.

## Cellular Telephones — **PLEASE Turn OFF Your Cell Phone**

Please be considerate of others. Ringers on cell phones and other electronic devices should be turned off or switched to vibrate or silence mode during conference education sessions, meetings, and social events.

## Conference Attire

We invite you to dress in comfortable business casual attire for the conference. Hotel meeting rooms can sometimes be chilly, so you are advised to bring a sweater or light jacket as well.

## Lost and Found

Please check with the hotel's front desk for lost and found items.

## Membership

Organizations or individuals interested in NACHC Membership, please contact the NACHC office at (301) 347-0400 or [membership@nachc.org](mailto:membership@nachc.org). During the conference, you can obtain a membership application by visiting the NACHC table in the Leonesa Ballroom Foyer.

## Consent to Use of Photographic Images

Registration and attendance at or participation in all NACHC conferences and other activities constitutes an agreement by the registrant to NACHC's use and distribution (both now and in the future) of the registrant's or attendee's image or voice in photographs, videotapes, electronic reproductions, audio files and/or contents of any communications of such events and activities.

## Pike Place Market

If you're looking for some fun and adventure while in Seattle, look no further than Pike Place Market. Founded in 1907, the Market is one of the oldest and largest continuously operating public markets in the United States. Hundreds of locally owned businesses are located in this Seattle landmark, and over 70 Washington farmers bring their bountiful and delicious fruits and vegetables to the Market. It also features beautiful arts and crafts, including the renowned Milagros Mexican Folk Art, a specialty shop that features hand-picked collections from across Mexico. Pike Place Market is open daily, 9:00am – 5:00pm, and is only a 10-minute walk from the Grand Hyatt Seattle.

## Commemorating 60+ years of the Migrant Health Movement

The National Center for Farmworker Health, Inc. (NCFH) has produced a wonderful slide presentation, *History of America's Agricultural Workers and the Migrant Health Movement*, that chronicles the rich history of modern-day agricultural work in the United States and how the Migrant Health Movement began.

This presentation can be viewed via the NACHC Mobile App and the NCFH website at <http://www.ncfh.org/history.html>.

**A walking exhibit of the presentation has been curated for the conference. It is located in the Portland Meeting Room during the following times:**

<b>Tuesday, May 2</b>	<b>7:30am – 5:00pm</b>
<b>Wednesday, May 3</b>	<b>7:30am – 6:00pm</b>
<b>Thursday, May 4</b>	<b>7:30am – 11:30am</b>



# Music Playlist/Liner Notes for Conference

Throughout the 2023 NACHC Conference for Agricultural Worker Health, a curated music playlist will be playing during sessions and breaks in celebration of 60+ years of the Migrant Health Program and the rich history of migratory and seasonal agricultural work in the United States.

The below information serves as the liner notes for the playlist. Liner notes are the writing found on the sleeves of record albums and in booklets, historically inserted into cassette or compact disc (CD) cases, to provide further commentary or explanatory notes about the musical recordings contained within.

The selections below are meant to be representative of the demographics of United States farmworkers, based on findings from the *National Agricultural Workers Survey (NAWS) 2017–2018: A Demographic and Employment Profile of United States Farmworkers Research Report No. 14*.

This playlist is not fully representative of the range of musical expression in the farmworkers' country of origin. That would be monumental and there are a lot of musical genres that are not fully represented or represented at all. Some traditional icons of regional music are not included in favor of new spins on tradition. We have included a handful of songs that have been part of United Farm Worker rallies, including a version of "Freedom Road" by The Blind Boys of Alabama, for example, and the rest of the playlist assembles songs based on country of origin and ethnicity.

We know that the selections cannot do full justice to the cultural diversity of our farmworker communities but attempts to be as representative as possible — for example, we have chosen Joy Harjo (Muskogee) and Xavier Quijas Yxayotl (Aztec) to point to the work of Indigenous peoples, R.L. Burnside to gesture to the rich delta blues tradition, and so on.

Ultimately, we have chosen music that is vibrant, alive, full of energy and verve. We have made the playlist living and collaborative, welcoming you to add your favorites or consider compiling your own inspiring playlist.

## Artists by Country/State of Origin

### West Central Mexico - Colima, Guanajuato, Jalisco, and Michoacán

- Mariachi Vargas de Tecalitlán, Jalisco/ Mexico City
- Beto y sus Canarios, Michoacán
- Maná, Guadalajara
- La Revolución de Emiliano Zapata, Guadalajara
- Chac Mool, Michoacán

### Northern Mexico - Aguascalientes, Baja California, Chihuahua, Coahuila, Mexico City, Durango, Estado de Mexico, Hidalgo, Nayarit, Nuevo Leon, Queretaro, San Luis Potosi, Sinaloa, Sonora, Tamaulipas, and Zacatecas

- Pinguinos del Norte, Rio Grande Region
- José-Luis Orozco, Mexico City
- Los Tigres del Norte, Sinaloa, Mexico
- José Alfredo Jiménez, Guanajuato
- Carla Morrison, Baja, California
- Ely Guerra, Monterrey, Nuevo León
- Christian Nodal, Sonora
- Xavier Quijas Yxayotl, Aztec

### Southern Mexico - Campeche, Chiapas, Guerrero, Morelos, Oaxaca, Puebla, Quintana Roo, Tabasco, Tlaxcala, Veracruz, and Yucatan

- Sonos Jarochos, Veracruz
- Radio Jarocho, Veracruz
- Grupo Mono Blanco, Veracruz
- Lila Down, Oaxaca

### United States

- Playlist from United Farm Worker Rallies
- El Teatro Campesino (NY)
- Blind Boys of Alabama (AL)
- Rosie Flores, San Antonio
- La Santa Cecilia, Los Angeles
- Las Cafeteras, LA (Jalisco)
- R.L. Burnside, MS
- Joy Harjo, Muskogee Nation
- Sudden Rush, Hawaii (to represent wide range of Indigenous peoples)

### Central America, Puerto Rico, Dominican Republic

- Rubén Blades, Panama
- Rebecca Lane, Guatemala
- Cocofunka, Costa Rica
- Gaby Moreno, Guatemala
- Anastasio y los del Monte, El Salvador
- Willie Colón, Puerto Rico
- Vicente García, Dominican Republic

Additional demographic information excerpted from findings from the *National Agricultural Workers Survey (NAWS) 2017–2018: A Demographic and Employment Profile of United States Farmworkers Research Report No. 14*.

### Birthplace, Work Authorization, and Migrant Types: Summary of Findings

- About 6 in 10 hired farmworkers were born in Mexico (64%).
- 77% of all farmworkers were Hispanic. Among US-born workers, 30% were Hispanic.
- 32% of farmworkers self-identified as White, 3% as Black or African American, and 65% of respondents did not select a category; instead, they described race with an open-ended "other" response.
- 6% of farmworkers were identified as Indigenous.

### States in Mexico

Among Mexico-born workers interviewed in 2017–2018, most came from the states of Michoacán (27%), Guanajuato (10%), Jalisco (10%), Oaxaca (10%), Baja California (6%), and Guerrero (5%). The greatest proportion of Mexico-born farmworkers originated from the Western Central region (49%), 28% came from Northern Mexico, and another 23% came from Southern Mexico.

# Delivering the support your community needs



**More Products,  
More Choice**



**Distribution You  
Can Count On**



**Support Every  
Step of the Way**



**Solutions  
to Enhance  
Your Center**

Count on McKesson to provide the right products and services to help you meet today's challenges and prepare for what's ahead.



**Call us** to learn more.  
866.MCK.ANSWer (866.625.2679)  
[mms.mckesson.com/  
community-health-centers](https://mms.mckesson.com/community-health-centers)



## Sowing Strength/Cultivando Fortaleza: Meeting Environmental, Social, and Care Challenges in Farmworker Health

# Program Events

(as of April 13, 2023 and subject to change)

NACHC is a nonpartisan and noncommercial organization. Conference speaker presentations may not necessarily reflect the views of NACHC and the presence of vendors and sponsors does not constitute endorsement of vendor products or services.

### Monday, May 1, 2023

1:00pm – 5:00pm	Sponsor Check-In and Setup	Leonesa Ballroom Foyer
3:00pm – 5:00pm	Registration and Speaker Check-In	Leonesa Ballroom Foyer

### Tuesday, May 2, 2023

7:30am – 8:30am	Continental Breakfast	Leonesa Ballroom Foyer
7:30am – 12:00pm 1:30pm – 4:00pm	Registration, Speaker and Sponsor Check-In	Leonesa Ballroom Foyer
7:30am – 5:00pm	Tabletop Exhibits Open	Leonesa Ballroom Foyer
7:30am – 5:00pm	<i>Walking Exhibit: Commemorating 60+ Years of the Migrant Health Movement</i>	Portland Meeting Room
8:30am – 10:00am	<p><b>AGS1 OPENING GENERAL SESSION</b></p> <p><b>Master of Ceremonies</b>  <b>Michael A. Holmes</b>, Chair, NACHC Board of Directors and Chief Executive Officer, Scenic Rivers Health Services</p> <p><b>Welcome Remarks</b>  <b>Rachel Gonzales-Hanson</b>, Interim President and CEO, NACHC</p> <p><b>Chair of the Board Remarks</b>  <b>Michael A. Holmes</b>, Chair, NACHC Board of Directors and Chief Executive Officer, Scenic Rivers Health Services</p> <p><b>Welcome to Washington</b>  <b>Bob Marsalli</b>, Chief Executive Officer, Washington Association for Community Health  <b>Abby Sears</b>, Chief Executive Officer, OCHIN</p>	Leonesa Ballroom

Some sessions of this conference program are supported by the Health Resources and Services Administration (HRSA), of the U.S. Department of Health and Human Services (HHS), as part of an award totaling \$6,719,843. The contents are those of the author(s) and do not necessarily represent the official views of, nor an endorsement by, HRSA, HHS, or the U.S. Government. For more information, please visit [HRSA.gov](https://www.hrsa.gov).



**Washington Migrant Health Centers Panel:  
Providing Access to Care for Agricultural Workers and Their Families**

Join panelists from Columbia Valley Community Health and Yakima Neighborhood Health Services to learn how Washington migrant health centers are providing access to care for agricultural workers and their families. Brief presentations on these programs will be followed by a discussion about challenges, emerging issues, and hopes for the future.

*Moderator:*

**Bob Marsalli**, Chief Executive Officer, Washington Association for Community Health

*Panelists:*

**Rhonda Hauff**, Chief Executive Officer, Yakima Neighborhood Health Services

**Manuel Navarro, MHA**, Chief Executive Officer, Columbia Valley Community Health

**Dulce Negrete**, Clinic Manager, Columbia Valley Community Health

**NACHC Policy Priorities**

**Rachel Gonzales-Hanson**, Interim President and CEO, NACHC

**Michael A. Holmes**, Chair, NACHC Board of Directors and Chief Executive Officer, Scenic Rivers Health Services

**Closing Remarks**

**Michael A. Holmes**, Chair, NACHC Board of Directors and Chief Executive Officer, Scenic Rivers Health Services

10:00am – 10:30am

Networking and Beverage Break

Leonesa Ballroom Foyer

The MEDCOR GROUP, Inc.

**"YOUR VISION, OUR MISSION"**

*Strength through Experience*

**When Better Matters... Why not Work with the best!**

**THE LEADING FQHC REVENUE CYCLE MANAGEMENT SOLUTION**

**Let MEDCOR Be Your Billing Partner.**

Call today for your FREE billing analysis at **1-714-221-8511**

**www.medcorinc.com**

The circular diagram contains the following text segments:

- Strength Through Experience**
- Solutions**
  - Processes
  - Audits
  - Training
  - Measured Outcomes
- Systems**
  - Multiple EMR Setups
  - Allscripts
  - eCW
  - NextGen
  - PF
  - Kareo
- Business Intelligence**
- KPI'S, Metrics, Dashboards**
- Productivity Analytics**

10:30am – 11:45am

EDUCATION SESSIONS

### **ATuA1 Si Se Puede: Living into the Legacy of Migrant Worker Organizing**

Princessa I

This session will explore the unique roles of agricultural workers, health center staff and board members, and community allies to equip people with the power (story and strategy) to make change that can be seen.

Upon completion of this session, participants will be able to:

- Understand the importance of agricultural workers and allies using organizing strategies to build power and work to change injustices that worsen health disparities and outcomes of agricultural workers.
- Gain insights into organizing for change in their communities.
- Identify ways to build capacity and mobilize agricultural workers and allies through storytelling and an intentional commitment to leadership that equips additional leaders.

*Presenters:*

**Jesus Blanco**, Community Outreach and PN Manager, Terry Reilly Health Services

**Susan Burton**, Director, National Grassroots Advocacy, NACHC

### **ATuB1 Expanding Food Security and Nutrition Services for Migrant and Seasonal Agricultural Workers**

Princessa II

Food insecurity, a social driver of health (SDOH), can have a significant impact on malnutrition, driving nutrition-related health inequities and chronic disease. Research shows that agricultural workers, especially migrant workers, Black households, Indigenous communities, and people of color are disproportionately impacted by food insecurity when compared to White households (Brookings, 2021). Fortunately, migrant and community health centers are uniquely poised to address food insecurity and its impact on health. As a part of their mission to target the roots of inequities, health centers have engaged in a number of innovative and successful food security and nutrition programs which require navigating multiple sectors (health care, public health, food access, social services, local agriculture) and building connections with new partners both within communities and statewide.

In this session, participants will learn how Family Health La Clinica (FHLC) applied a policy, systems, and environmental (PSE) approach to mitigate and eliminate chronic and acute malnutrition within their community. FHLC strategically utilizes public health and community nutrition registered dietitian nutritionists (PHCN RDNs) to identify the causes of nutrition-related needs and influence culturally responsive food and nutrition interventions. Moreover, FHLC has integrated both the services of a PHCN RDN and SDOH tracking into mobile primary care using clinically-validated questions and components via Protocol for Responding to and Assessing Patient Assets, Risks, and Experiences (PRAPARE) for migrant and seasonal agricultural workers (MSAWs). Learn more about how FHLC is advancing health equity in their migrant and seasonal agricultural worker population by shifting the focus from food security to food and nutrition security, and incorporating an assets-based, person-centered approach to care.

Upon completion of this session, participants will be able to:

- Identify similarities and differences between hunger, food security, and nutrition; and how they impact health equity and community health.
- Examine a successful model for the integration of a PHCN RDN into MSAW mobile primary care.
- Leverage statewide food and nutrition resources, programs, and people to improve nutrition security among MSAW populations.

*Presenters:*

**William Kinsey, MD**, Medical Director Migrant Mobile Services, Family Health La Clinica

**Erika Anna, MS, RDN**, Teaching Faculty, University of Wisconsin-Madison

**Sarah Halpin, MPH**, Program Specialist, Social Drivers of Health, NACHC

11:45am – 12:00pm

Networking and Beverage Break

Leonesa Ballroom Foyer

12:00pm – 1:30pm

**Migrant Health Awards and Networking Luncheon**

Leonesa Ballroom

**Welcome Remarks and Master of Ceremonies**

**Paloma Hernandez, MPH, MS**, Chair-Elect, NACHC Board of Directors and President and CEO, Urban Health Plan

**Presentation of 2023 NACHC Migrant Health Awards**

**Michael A. Holmes**, Chair, NACHC Board of Directors and Chief Executive Officer, Scenic Rivers Health Services

**Lathran Woodard**, Immediate Past Chair, NACHC Board of Directors and Chief Executive Officer, South Carolina Primary Health Care

**Outstanding Migrant Health Public Service Award**

**Outstanding Migrant Health Center Board Member Award**

**Outstanding Migrant Health Center Award**

**Lifetime Achievement in Migrant Health Award**

*(refer to page 16 for a complete list of 2023 Migrant Health Awardees)*

**2023 National Center for Farmworker Health Commemorative Artwork Unveiling and Presentation of 2023 National Center for Farmworker Health Scholarship Awards**

**John Santistevan**, Treasurer, NACHC Board of Directors and Chief Executive Officer, Salud Family Health Centers

**Steve Weinman**, Board Chair, National Center for Farmworker Health and Principal, FQHC Associates

**2023 Commemorative Artwork**

Artist Presentation: **Arcadio Viveros**

**The History of Punjabi Farmworkers in Washington**

**Jennie McLaurin, MD, MPH, FAAP**, Senior Fellow, Public Health Integration and Innovation, NACHC



**Shub-Chintan Kaur**

Choreographer/Director of  
*Rhythms of India* dance school

**Rhythms of India Performance**

*Rhythms of India*, a local dance troupe, will perform “Bhangra,” a folk dance including vocal poems and drums, which celebrates the harvest from the Punjab region of India. Many Sikh Indians from this region have migrated to Washington State to work in the berry fields.

Enjoy this magical performance as dancers share the spirit and cultural appreciation of the folk dance of Bhangra.

**Closing Remarks**

**John Santistevan**, Treasurer, NACHC Board of Directors and Chief Executive Officer, Salud Family Health Centers

1:30pm – 2:00pm

Networking and Beverage Break

Leonesa Ballroom Foyer

# National Center for Farmworker Health Annual Commemorative Artwork and Scholarships

## Meet the Artist ... Arcadio Viveros

**Tuesday, May 2, 2023**

1:30pm – 2:00pm

3:15pm – 3:45pm

Leonesa Ballroom Foyer

**Wednesday, May 3, 2023**

10:00am – 10:30am



I am a retired health care executive who has devoted my entire professional life to improving the health and living conditions of migrant farmworkers and their families. I continue to be involved in the Migrant Health Movement by volunteering as board vice-president for the San Benito Health Foundation in Hollister, California. I have also served on the National Center for Farmworker Health Board and DHHS' National Advisory Council on Migrant Health working to improve the health and living conditions of our nation's most vulnerable population. In my retirement, I am fulfilling my lifelong desire to apply my artistic talents in documenting the experiences and suffering of US migrant farmworkers and their families.

My artwork usually reflects themes revolving around a farmworker's life. I think about migrant families as they move from place to place along the migrant stream in search of work. They may wonder where they will find a place to stay-- a house, apartment, garage, or to simply ask if someone will let them stay in their backyard or home. During my time as a farmworker, I vividly remember my parents worrying about those basic human needs and especially about health care access-- where would they take their children for care if there was a health emergency? There were no clinics, no doctors, not even a nurse in most of the places we lived. Thanks to the Migrant

Health Movement, thousands of US communities now have access to a health home where high-quality health care is provided to our poor, migrant, and indigent families. I experienced, firsthand, the farmworker's harsh life. As a 14-year old, I labored alongside grown men in harvesting fruits and vegetables in the California fields while traveling from the Imperial Valley, near the US-Mexican Border, to the fertile Central San Joaquin Valley.

I am pleased to present an art piece that honors the farmworker women, "La Virgen Campesina" or Farmworker Woman. She is experiencing difficult times as a farmworker, working hard all day, worrying about her children-- if they make it safe to and from school. Being the principal family nurturer and spiritual guardian, her days don't end at punching a timecard at work, but continue day in and day out, often into the late hours of the night. She is the last one to go to bed and the first to rise, to pack a lunch, prepare, and take the children to school. I wanted to present an allegorical representation of the farmworker woman-- that beyond all her suffering, there is a mystical air about her, she appears graceful, positive, jubilant, happy, thankful, with a true sense of gratitude. Although giving us so much personal sacrifice, and hard work, she is now offering the fruits of her labor, splendidly, so we can enjoy life.

---

*A limited number of fine art prints, commemorative posters, and greeting cards are available for purchase during the conference. Proceeds of art sales benefit the National Center for Farmworker Health (NCFH) Scholarship Fund and awards will be made next year based on the volume of sales from this year's artwork.*

*Scholarship awards in the amount of \$1,500 each will support degree programs and scholarship awards in the amount of up to \$1,000 will support those pursuing a certificate or other educational opportunity. The scholarship recipients are individuals who are currently employed or serve as board members at community health centers and have chosen to advance their education and recommit to improving access to care for the agricultural worker as their career path. Awardees represent a variety of health professions, disciplines, and backgrounds.*

**Come join us for the artwork unveiling and presentation of scholarships during the Migrant Health Awards and Networking Luncheon.**

2:00pm – 3:15pm

EDUCATION SESSIONS

**ATuA2 Revenue Generation and Philanthropic Endeavors for Migrant Health Programs**

Princessa I

Migrant health centers traditionally see a greater percentage of uninsured patients and have operated on more slim margins than their counterparts. Emergency COVID-19 funding bolstered revenue streams for many, enabling them to provide critical frontline services to migrant and seasonal agricultural workers throughout the pandemic. With COVID-19 emergency funding winding down and inflation continuing to impact operational costs, health centers are faced with an ever-widening budget gap. Migrant health centers seek funding from private foundations and donations to support those gaps in funding from Medicaid or their federal grant. Through all of this, compliance and ensuring proper systems are in place to manage a diverse revenue portfolio is essential. The dreams of the fundraising department may not always align with the practicalities of the finance department -- but there is a recognition that it is essential to work together for the good of the health center and community served.

Health center leaders will join senior-level NACHC experts for a robust discussion on the always growing needs for additional revenue resources and the work it takes to manage these dollars once they are received. Audience engagement and a safe space for questioning will be emphasized in this session, as the importance of sharing among peers often helps to find the best solutions to big challenges.

Upon completion of this session, participants will be able to:

- Recognize promising practices and approaches to revenue diversification that can be replicated at their health center.
- Identify common misperceptions on managing diverse revenues.
- Recognize that their health center is not alone in its own revenue diversification challenges and identify peers to relate with.

Presenters:

**Faith Polkey, MD, MPH**, Chief Executive Officer, Beaufort Jasper Hampton Comprehensive Health Services, Inc.

**Stefanny Caballero**, Executive Director, Virginia Garcia Memorial Foundation

**Jason Patnosh**, Associate Vice President, Development and Innovation, NACHC

**Gervean Williams, MS, MIT**, Director, Finance Training and Technical Assistance, NACHC

## 2023 NACHC Migrant Health Award Recipients

### 2023 Outstanding Migrant Health Center Award



**Blue Ridge Community Health Services**  
Hendersonville, North Carolina

### 2023 Lifetime Achievement in Migrant Health Award



**Karen Mountain, MBA, MSN, RN**  
Chief Executive Officer  
Migrant Clinicians Network  
Austin, Texas

### 2023 Outstanding Migrant Health Center Board Member Award



**William Morgan**  
Board Member  
Keystone Rural Health Center  
Chambersburg, Pennsylvania



**Victoria Montoya**  
Board Secretary  
San Benito Health Foundation  
Hollister, California

### 2023 Outstanding Migrant Health Public Service Award



**Edward C. Garza**  
Chief Executive Officer  
Mexican American Council  
Homestead, Florida



**ATuB2 Achieving Optimal Health for Agricultural Workers and Their Families Must Include Access to Pharmacy Services and Dental Care**

Princessa II

To achieve optimal health for agricultural workers and their families, access to pharmacy and dental services is essential. This session will provide a sampling of pharmacy programs that have improved access to agricultural workers and their families, tools that can be used to improve pharmacy operations in your health center, guidance on how training your own dental assistants can facilitate achieving a workforce that reflects the communities served, and the steps needed to include dental therapists on the dental care team. The sampling will be followed by the opportunity to explore two of these topics in more detail.

Upon completion of this session, participants will be able to:

- Apply new approaches to pharmacy access to improve the health of agricultural workers and their families.
- Determine how their health center/PCA can recruit from the community, train, and retain dental assistants and pharmacy staff.
- Explain the role of dental therapists and the steps needed to utilize dental therapists on their health center care teams.

*Moderator:*

**Donald L. Weaver, MD**, Assistant Surgeon General, USPHS (retired) and Senior Partner, Martin, Blanck & Associates

*Presenters:*

**Yadira Martinez, RDH, EPDH, DT**, Dental Hygiene Program Manager, Virginia Garcia Memorial Health Center

**Martine Woolley, PharmD, MS, MBA**, Vice President of Pharmacy, Healthcare Network

**Desiree Sweeney, MBA**, Chief Executive Officer, NEW Health

**Lindsey Ruivivar**, Chief Strategy Officer, NEW Health

**Danielle Sobel, MPH**, Senior Director, Policy and Regulatory Affairs, Oregon Primary Care Association



**Insurance  
as it  
should be**  
[nonstophealth.com](https://nonstophealth.com)



Nonstop is a proud participant in the Value in Benefits program from Community Health Ventures, business affiliate of the National Association of Community Health Centers.

CA #0111857, TPA

For a complete list of states and license numbers, please visit [nonstophealth.com/licenses](https://nonstophealth.com/licenses)



3:15pm – 3:45pm

Networking and Beverage Break

Leonesa Ballroom Foyer

3:45pm – 5:00pm

EDUCATION SESSIONS

### **ATuA3 Good Governance Practices Essential to Serving Migrant and Seasonal Worker Populations**

Princessa I

When a health center serves the migratory and seasonal agricultural worker (MSAW) population, its board plays an essential role in setting strategy and providing oversight to ensure MSAW needs are being met. This session will address good governance practices for boards to use when a health center serves the MSAW population. Practices covered will include: structuring board orientation and board education to ensure all board members understand the MSAW community served by the center and its changing needs; leveraging the needs assessment and strategic planning process to serve this population; supporting access goals for MSAWs; and tips for board meeting structures to support ongoing monitoring of strategy and programs serving MSAWs.

Upon completion of this session, participants will be able to:

- Identify practices for ensuring board orientation and ongoing education addresses MSAW needs.
- Discuss how to use the needs assessment and strategic planning process to define MSAW-specific priorities and clear access goals.
- Identify practices to take back to their board to strengthen its governance performance in serving MSAW populations.

*Presenters:*

**Alicia Gonzales, MSSW**, Chief Operating Officer, National Center for Farmworker Health

**Lisa Miller, MA**, Training Services Manager, National Center for Farmworker Health

**Deb Salazar**, Migrant Health Director, Salud Family Health

**Jesus Tijerina**, Board Chair, Salud Family Health

### **ATuB3 Outreach and Education: Lessons Learned from Immunizations, Outreach, and Asthma Programming**

Princessa II

This session will focus on increasing immunization access and outreach for migratory populations along with promotora-led asthma community-based education. Holistic preventive care for migratory populations continues to be important for optimal health outcomes. Immunizations, asthma control, outreach, and education are important components of holistic care. Explore how Camarena Health, in collaboration with UC Merced, had *promotoras de salud* (community health workers) conduct home visitation interventions to families affected by asthma. Modules focused on asthma scope, environmental triggers, medication delivery, and monitoring. Individual interviews assessed program impact, and pre-and post-program surveys assessed asthma knowledge, health behaviors, and asthma control.

This presentation will also highlight the model of passing grant funding through a patient care association to community health centers and community-based organizations to provide COVID-19 vaccine education and support to MSAW communities through the work of their community health worker outreach teams.

Upon completion of this session, participants will be able to:

- Explore key activities of health centers serving migrant farm workers in holistic ways and gain a renewed understanding of the general landscape of adult immunizations and asthma in the US.
- Identify challenges and useful practices to implementing a community engagement approach that integrates promotoras for an asthma management and control education program.
- Describe the benefits of using a pass-through model to maximize grant funding.

*Moderator:*

**Seth Doyle, MA**, Community Health Improvement Program Manager, Northwest Regional Primary Care Association

*Presenters:*

**Kelly Volkman, MPH**, Project Director, Community Health Worker Institute, Northwest Regional Primary Care Association

**Lizette Contreras, MBA**, Director of Community Development, Camarena Health

**Claudia Chavez**, Community Engagement Manager, Camarena Health

**Maria Meraz**, Community Health Worker, Camarena Health

**Nancy Dhaliwal**, Community Health Worker, Sea Mar Community Health Center



For **Health Centers** by Health Centers



## Sí se puede.

“Every moment is an organizing opportunity, every person a potential activist, every minute a chance to change the world.”

– Delores Huerta, American labor leader, civil rights activist, and feminist

**CHV is proud to support NACHC and the member health centers who provide needed services to America’s most essential employee, the agricultural worker.**

Value in Purchasing



Value in Benefits



Value in Staffing



Value in Dental



Value in Laboratory



Business  
Affiliate of:



NATIONAL ASSOCIATION OF  
Community Health Centers®



Community Health Ventures, Inc. | 211 N Union Street | Suite 200 | Alexandria, VA 22314

[p] 1-888-299-0324 [f] 703-995-0817 [e] ventures@nachc.com

7:30am – 8:30am	Continental Breakfast	Leonesa Ballroom Foyer
7:30am – 8:30am	<b>Conversation and Coffee for Health Center Board Members</b>	Leonesa Ballroom
7:30am – 11:45am 1:30pm – 3:15pm	Registration, Speaker and Sponsor Check-In	Leonesa Ballroom Foyer
7:30am – 4:00pm 4:30pm – 5:45pm	Tabletop Exhibits Open	Leonesa Ballroom Foyer
7:30am – 6:00pm	<i>Walking Exhibit: Commemorating 60+ Years of the Migrant Health Movement</i>	Portland Meeting Room
8:30am – 10:00am	<b>AGS2 GENERAL SESSION</b>	Leonesa Ballroom

### Welcome Remarks and Master of Ceremonies

**Paloma Hernandez, MPH, MS**, Chair-Elect, NACHC Board of Directors and President and CEO, Urban Health Plan

### Welcome from Northwest Regional Primary Care Association

**Bruce Gray, MPA**, Chief Executive Officer, Northwest Regional Primary Care Association

### HRSA Bureau of Primary Health Care Update



**Tonya Bowers, MHS**

Deputy Associate Administrator,  
Bureau of Primary Health Care,  
Health Resources and Services  
Administration

Tonya Bowers is the Deputy Associate Administrator of the Bureau of Primary Health Care (BPHC), Health Resources and Services Administration (HRSA). BPHC supports nearly 1,400 health centers that operate approximately 14,000 service delivery sites in every US state, the District of Columbia, Puerto Rico, the US Virgin Islands, and the Pacific Basin. Serving nearly 30 million people nationwide, these centers provide cost-effective, comprehensive, and patient-centered care, coordinating a wide range of medical, dental, behavioral, and patient services.

From March 2020 to December 2020, Bowers led policy and provider engagement operations for HRSA's Provider Relief Fund, overseeing the disbursement of over 400,000 payments totaling more than \$100 billion to providers to ensure the US health care system remained financially viable during the COVID-19 pandemic. Bowers also served as acting Associate Administrator for BPHC from April 2015 to April 2017. Bowers previously served as the director of the Office of Policy

and Program Development in BPHC, where she oversaw the expansion of HRSA-supported programs through more than \$6 billion in funding awarded under both the American Reinvestment and Recovery Act and the Affordable Care Act, and she served in several other capacities at BPHC from 1995 to 2008. She has been instrumental in the maturation of the program, helping to develop the key Health Center Program requirements and accompanying guidance and technical assistance. Before joining HRSA in 1995, Bowers worked at a health center in Connecticut. Bowers graduated from Trinity College (Connecticut) with a degree in third world studies and religion, and she has a Master of Health Science in health policy from the Johns Hopkins School of Public Health and Hygiene.



### Policy Panel: H-2A Visa Spotlight

Since 2016, the H-2A temporary agricultural visa program has more than doubled. In 2022, the US Department of Labor certified 371,619 H-2A positions with Florida, California, Georgia, Washington, and North Carolina as the top five states for H-2A employment. With the continued growth of the H-2A program, it is important that health centers have resources to support workers and connect them to resources, including health care.

Panelists will discuss the national, state, and local resources available to support H-2A workers while in the United States. The panel will begin with an overview of the H-2A program, including worker protections, and then discuss the role of state agencies, successful strategies for outreach, and collaborations between state and local agencies and community-serving organizations (such as health centers).

Upon completion of this session, participants will be able to:

- Provide an overview of the current state of the H-2A program in the US.
- Understand the Department of Labor's role in protecting rights of H-2A and domestic farmworkers.
- Share strategies to conduct outreach to H-2A workers and connect them to their health centers.

*Moderator:*

**Alexis Guild, MPP**, Vice President, Strategy and Programs, Farmworker Justice

*Panelists:*

**Uriel Iñiguez, MPA**, Director of Community Relations, Washington State Department of Labor and Industries

**Sheila Berschauer**, Chief Executive Officer, Moses Lake Community Health Center

### Closing Remarks

**Paloma Hernandez, MPH, MS**, Chair-Elect, NACHC Board of Directors and President and CEO, Urban Health Plan

A promotional banner for the Virtual 2023 Biennial Workforce Summit. The banner features a dark blue background with a glowing globe, a hand holding a smartphone, and various icons like a lightbulb, a handshake, and a magnifying glass. The text is in white and teal. A QR code is located in the bottom right corner.

**Virtual 2023 Biennial  
WORKFORCE  
SUMMIT**

**May 23-24, 2023: 12:00-5:00PM ET**

Presented by ACU's STAR<sup>2</sup> Center,  
Community Health Center, Inc., and the  
National Association of Community Health Centers



SCAN ME



### **AWA1 Integrating Justice, Equity, Diversity, and Inclusion for Agricultural Workers in Strategic Planning**

Princessa I

Migrant and seasonal agricultural workers have historically faced discriminatory and inequitable treatment that has exposed them to hazardous conditions resulting in poor health outcomes. How might health center boards and administrators utilize a justice, equity, diversity, and inclusion (JEDI) lens to address these challenges in their strategic planning? Through this session, attendees are expected to increase awareness of the unique historical and contemporary challenges faced by agricultural workers, understand approaches for integrating JEDI for agricultural workers into strategic planning, and explore the roles of board members and administrators in creating a culture of inclusion to better meet the needs of agricultural workers.

Don't miss the opportunity to hear this panel of experienced health center leaders and partners share promising practices to build an institutional culture to advance equity and social justice for agricultural workers.

Upon completion of this session, participants will be able to:

- Recognize unique historical and contemporary challenges faced by agricultural workers.
- Understand approaches for applying a JEDI lens to strategic planning for agricultural worker health services.
- Compare and contrast the role that board members and senior leaders may play in creating a culture of inclusion to better meet the needs of agricultural workers.

*Moderator:*

**Gerrard Jolly, MA, CDP**, Director, Career Advancement Strategies, NACHC

*Presenters:*

**Gladys Carrillo, MSW**, Director of Program Services, National Center for Farmworker Health

**Anne Kauffman Nolan, MPH**, Chief Executive Officer, Sun River Health

**Sandra Oxford**, Board Member, Sun River Health

**Marisa Atencio**, Director of Clinical Support Services, Valley-Wide Health Systems, Inc.

**Celina Espinoza**, Board Chair, Valley-Wide Health Systems, Inc.

### **AWB1 Promoting Health Care Access for Lesbian, Gay, Bisexual, Transgender, Queer, Intersex, and Asexual Farmworkers**

Princessa II

There is a common misconception that few or no lesbian, gay, bisexual, transgender, queer, intersex, asexual, and all sexually and gender diverse (LGBTQIA+) people exist within the farmworker community. As a result, the health care needs of LGBTQIA+ farmworkers are often overlooked. It is important for health centers to recognize and address the unique challenges faced by LGBTQIA+ farmworkers in order to provide high-quality care to this marginalized population. In this session we will discuss the unique health care challenges facing LGBTQIA+ farmworkers, and share best practices for health centers to build trust with these communities.

*(Sources: Hannan J. Trans, Immigrant Farmworkers Peel Back 'Layers of Invisibility.' NBC News 2016. Available at: <https://www.nbcnews.com/feature/nbc-out/trans-undocumented-immigrants-peel-back-layers-invisibility-rural-california-n603151> Jerke, B. W. (2011). Queer ruralism. *Harvard Journal of Law & Gender*, 34(1), 259-312.)*

Upon completion of this session, participants will be able to:

- Describe the unique health care challenges facing LGBTQIA+ farmworkers.
- Apply best practices for engaging and retaining LGBTQIA+ farmworkers in care at health centers.
- Identify available support systems for LGBTQIA+ farmworkers and their care teams at health centers.

*Moderator:*

**Alex Keuroghlian, MD, MPH**, Director, National LGBTQIA+ Health Education Center, Fenway Health

*Presenters:*

**Alexis Guild, MPP**, Vice President, Strategy and Programs, Farmworker Justice

**Carlos Rodriguez-Diaz, PhD, MPHE, MCHES**, Associate Professor of Prevention and Community Health, The George Washington University-Milken Institute School of Public Health

**Jack Bruno, MSW**, Operations Coordinator, National LGBTQIA+ Health Education Center, Fenway Health

## Wednesday, May 3, 2023, continued

---

11:45am – 1:30pm

Lunch on your own

1:30pm – 2:45pm

EDUCATION SESSIONS

### **AWA2 Course of Actions to Building Resilience Among Agricultural Worker Communities**

Princessa I

During the past few years it has become increasingly clear that agricultural workers are essential workers and are among some of the nation's most vulnerable communities. Over 175 Federally Qualified Health Centers (FQHCs) receive funds to assist agricultural workers and their families with access to health care. To accomplish this, FQHCs must understand the uniqueness of their own communities and the risks and barriers that are often associated with this essential worker population. All activities that address barriers for agricultural workers can and do increase the resilience of the community.

In this session, we will discuss several innovative outreach activities to assist with building resilience among agricultural worker communities.

Upon completion of this session, participants will be able to:

- Understand the different needs of the agricultural worker and how they might differ from other workers in the community.
- Identify clinical and administrative areas of opportunity in integration with community health worker services and outreach efforts for farmworker populations.
- Become familiar with community integration engagement processes that focus on “actionable” approach during public health emergencies for CHCs and the role of community health workers in successfully implementing plans.

*Presenters:*

**Jean Paul Roggiero, MPA**, Director of Community Outreach, Healthcare Network of SWFL

**Mari Valentin, MLA**, Director, Agricultural Worker Health Program, Beaufort Jasper Hampton Comprehensive Health Services, Inc.

**Emily Harris, MPH**, Manager of Public Health Programs, Chiricahua Community Health Centers, Inc.

**Rachelle Walker**, Outreach Coordinator, Beaufort Jasper Hampton Comprehensive Health Services, Inc.

### **AWB2 Whole Person Care: SDOH Screening, Mental Health and Trauma-Informed Care for Migratory and Seasonal Agricultural Workers**

Princessa II

Social drivers of health (SDOH) largely impact communities that are marginalized because they are most often burdened by their negative effects. Research shows that health care access for migratory and seasonal agricultural workers (MSAWs) are disproportionately affected by SDOH including workplace harassment/sexual assault and intimate partner violence (IPV). This presentation will provide an overview of the importance of screening for SDOH to identify key barriers to care and feature health center innovative screening techniques and workflows for specific SDOH factors amongst MSAW populations. The panel will also share existing tools and resources to address SDOH, including a new safety card tool on IPV.

Upon completion of this session, participants will be able to:

- Understand the impact of SDOH factors, including workplace sexual assault/harassment and IPV, on MSAW health.
- Identify SDOH factors and implement SDOH screening tools into their health center workflows.
- Implement strategies to improve how a health center identifies and responds to SDOH needs, including IPV, workplace assault, and human trafficking, to support patient safety and improve health outcomes.

*Moderator:*

**Yuriko de la Cruz, MPH, CPHQ**, Program Manager, Social Drivers of Health, NACHC

*Presenters:*

**Elena Josway, JD**, Program Director, Futures Without Violence

**Mily Trevino-Sauceda, MSS**, Executive Director and Co-Founder, Alianza Nacional de Campesinas, Inc.

**Alexis Guild, MPP**, Vice President, Strategy and Programs, Farmworker Justice

**Gladys Carrillo, MSW**, Director of Program Services, National Center for Farmworker Health

2:45pm – 3:15pm

Networking and Beverage Break

Leonesa Ballroom Foyer

3:15pm – 4:30pm

EDUCATION SESSIONS

### **AWA3 Caring for the Care Team: A Role for the Arts in the Health Center Workforce Well-Being Toolkit**

Princessa I

This session will focus on “Connectivity and Community,” one of the “Five Essentials for Workplace Mental Health & Well-Being” as cited in the *U.S. Surgeon General’s Framework for Mental Health & Well-Being*. In addition to reviewing the “Five Essentials” of the Surgeon General’s Framework, participants will have an opportunity to learn how to utilize the health benefits of arts participation. Data on participating in the arts is associated with better scores on measures for mental health, physical health, and quality of life.

This session will feature Dr. Faith Polkey, the CEO of Beaufort Jasper Comprehensive Health Services, Inc. – a health center serving agricultural workers in rural South Carolina. Dr. Polkey will share her experience with the role of the arts in her health center leadership journey for both professional development and team building. Session activities will include hands-on experience with the role of the written word (poetry, play, or a speech) as a tool to facilitate health center staff conversations about teamwork – an important component of the Surgeon General’s Framework.

Upon completion of this session, participants will be able to:

- Provide an overview of the Surgeon General’s “Five Essentials for Workplace Mental Health & Well-Being.”
- Discuss the role of arts participation to promote health center staff well-being.
- Experience the use of the written word (poetry, play, or a speech) to facilitate conversations that promote teamwork.

*Moderator:*

**Grace Wang, MD, MPH, FAAFP**, Senior Fellow, Public Health Integration and Innovation, NACHC

*Presenter:*

**Faith Polkey, MD, MPH**, Chief Executive Officer, Beaufort Jasper Hampton Comprehensive Health Services, Inc.

### **AWB3 Developing Sustainable Telehealth Programs to Support Farmworker Patients**

Princessa II

Telehealth serves as an important tool to connect farmworkers to health care. It achieves the *quadruple aim*, improving population health, reducing cost of care, enhancing the patient experience, and improving provider satisfaction. Health centers improved their telehealth capacity during the COVID-19 pandemic, yet many struggle to fully integrate it into their health system. This session will discuss strategies to implement sustainable telehealth programs at health centers.

The workshop will feature presenters from Finger Lakes Community Health, Migrant Clinicians Network, Farmworker Justice, and the National Migrant and Seasonal Head Start Collaboration Office. They will share challenges, successes, and promising practices related to telehealth implementation, including the benefits to patients, clinicians, and administrators. Participants will have the opportunity to share their experiences and questions.

Upon completion of this session, participants will be able to:

- Understand the benefits of implementing telehealth for both farmworker patients and the health center.
- Share challenges and successes of telehealth programs.
- Utilize resources and tools to develop a sustainable telehealth program at their health center.

*Moderator:*

**Alexis Guild, MPP**, Vice President, Strategy and Programs, Farmworker Justice

*Presenters:*

**Mary Zelazny, MBA**, Chief Executive Officer, Finger Lakes Community Health

**Jillian Hopewell, MPA, MA**, Chief Program Officer, Education and Communication, Migrant Clinicians Network

**Sirene Garcia**, Chief Innovation Officer, Finger Lakes Community Health

**Guadalupe Cuesta**, Director, National Migrant and Seasonal Head Start Collaboration Office

## Wednesday, May 3, 2023, continued

4:30pm – 5:45pm

### Networking Reception

Leonesa Ballroom Foyer

5:45pm – 7:30pm

### Evening Tour of the Sea Mar Museum of Chicano/a/Latino/a Culture

Off-Site

The museum is located only 15 minutes from the hotel. This is a first-of-its kind museum in the Pacific Northwest, focused on presenting the farmworker migration story, civil rights experience, and related history through a social justice lens. Learn more about this amazing museum at <https://seamarmuseum.squarespace.com/about>. *(The cost of this tour is included in your conference registration fee.)*

#### The schedule for this *optional* evening event follows:

5:45pm – 6:00pm Buses load at the 7th Avenue side entrance of Grand Hyatt Seattle

6:00pm Buses depart for Sea Mar Cultural Museum

6:15pm – 7:15pm Sea Mar Cultural Museum Welcome and Tour

7:15pm – 7:30pm Buses load at the Sea Mar Cultural Museum

7:30pm Buses depart for Grand Hyatt Seattle

*The transportation for this event is sponsored by*



## Molina Healthcare is a proud sponsor of the 2023 Conference for Agricultural Worker Health

Thank you for your dedication to the health and well-being of our community.

To learn more about sponsorship opportunities with Molina, please contact Sonia Morales at [Sonia.Morales@MolinaHealthcare.com](mailto:Sonia.Morales@MolinaHealthcare.com).

MeetMolinaWA.com



7:30am – 8:30am	Continental Breakfast	Leonesa Ballroom Foyer
7:30am – 9:00am	Tabletop Exhibits Open	Leonesa Ballroom Foyer
7:30am – 10:00am	Registration and Speaker Check-In	Leonesa Ballroom Foyer
7:30am – 11:30am	<i>Walking Exhibit: Commemorating 60+ Years of the Migrant Health Movement</i>	Portland Meeting Room
8:30am – 11:30am	<b>AGS3 CLOSING GENERAL SESSION</b>	Leonesa Ballroom

### Master of Ceremonies

**Rachel Gonzales-Hanson**, Interim President and CEO, NACHC

### Keynote



**Rosalinda Guillen**

Founder and Executive Director  
Community to Community

Rosalinda Guillen is the founder and executive director of Community to Community (C2C) and a lead strategist and visionary within the non-hierarchical ecofeminist leadership of C2C. Her perspective is fundamentally influenced by her introduction to the multi-racial, working-class community organizing model of the Rainbow Coalition, the Cesar Chavez house meeting model, the World Social Forum, Brazil's Landless Workers Movement, *Movimento dos Trabalhadores Rurais Sem Terra (MST)*, and growing up a farmworker in La Conner, Washington. Rosalinda has organized farmworkers in Washington State and the strawberry fields of Salinas, California. She has represented farmworkers in the California and Washington State legislatures and in ongoing policy and Movement-building dialogues on immigration issues, climate change, labor rights, trade agreements, ecofeminism, and strengthening the food sovereignty movement towards a Solidarity Economy.

### Building Community Health Center and Agricultural Worker Resilience to Extreme Heat and Climate Change

A changing climate is causing more intense heatwaves, wildfires, hurricanes, and flooding. Unfortunately, these issues disproportionately impact people who work outside (such as agricultural workers), communities of color, individuals with limited income, and those who have chronic diseases. Most climate adaptation and response has been focused on building resilient infrastructure, with limited attention on community members who are most at risk for severe health implications from these climatic events. Furthermore, investments in infrastructure have largely been concentrated on large health care facilities and urban hospitals; not at migrant and community health centers. Ultimately, community health centers serving agricultural workers need to be supported and equipped so that clinicians, administrators, and patients are prepared for heat, storms, and other events associated with climate change.

In this session, presenters from the National Association of Community Health Centers, Migrant Clinicians Network, and Moses Lake Community Health Center will share their practices, resources, and stories focused on building resilience and preparedness for extreme heat and other climate change events that disproportionately impact agricultural worker populations.

Upon completion of this session, participants will be able to:

- Identify the risks to health center operations and agricultural worker health from climate events, especially extreme heat.
- Discuss practices and resources that build community health center resilience and preparedness for extreme heat and other climate events.
- Discuss practices and resources available to address and prevent extreme heat exposure for agricultural worker populations.



*Moderator:*

**Jessica Hinshaw, MPH**, Environmental Health Program Manager, NACHC

*Presenters:*

**Jillian Hopewell, MPA, MA**, Chief Program Officer, Education and Communication, Migrant Clinicians Network

**Mary Jo Ybarra-Vega, MS, LMHC**, Outreach/Behavioral Health Coordinator, Moses Lake Community Health Center

### **Ag Worker Access Campaign: It Can't Be Done Without You! 2023 Increase Access to Care: Promising Practices Awards**

Four and half million migratory and seasonal agricultural workers (MSAWs) and their families are estimated to currently reside in the US. This special population that is so integral to the health and well-being of our families, and to the overall US economy, often does not have access to basic health care for their own families. Sixty years after passage of the Migrant Health Act, Ag Worker Health Champions continue their work to ensure access to quality health care for MSAW families through the Ag Worker Access Campaign. The Campaign began in 2015 as a national effort to increase the number of MSAWs and their families seen in health centers across the US. It focuses on improving the health outcomes of this special population, including addressing social drivers that affect health care access by identifying challenges, exploring and launching innovation, supporting collaboration and coalition building, and identifying and disseminating promising practices.

According to 2021 UDS data, 1,015,162 MSAWs and their family members were served in health centers. As we celebrate this accomplishment, we want to be intentional about our plan to build upon it. In this session, participants will receive the latest updates on the Ag Worker Access Campaign and the benefits of joining this initiative, learn about the 2023 Increase Access to Care for Agricultural Workers (IAC) Program Promising Practices Award recipients, and identify participants' integral role as Ag Worker Health Champions within their spheres of influence.

*Presenter:*

**Lisa Miller, MA**, Training Services Manager, National Center for Farmworker Health

### **First Time Home Documentary Film Screening and Panel Discussion**

#### **Introduction**

**Ronald Yee, MD, MBA, FFAFP**, Chief Medical Officer, NACHC

*First Time Home* is a film directed and shot by young people who are Indigenous Triqui, second-generation immigrants, and cousins: Herbierto Ventura, Esmeralda Ventura, Noemi Librado-Sanchez and Esmirna Librado (Noemi and Esmirna will join us live for a filmmaker discussion after the screening). *First Time Home* is their story, told as they wish to tell it.

When the four cousins learned their grandfather in Mexico was gravely ill, they travelled from their immigrant community in California to their family's ancestral village in Oaxaca for the first time. The teenagers recorded video letters to share with their parents and other relatives in the US, who are farmworkers and have not seen their relatives in Mexico in over 15 years. Through a mixture of Spanish, Triqui, and English, the four cousins got to know their grandparents, aunts, and uncles. In the midst of border politics and violence, they forged a link across thousands of miles, developing a newfound pride in their indigenous immigrant identity and a new understanding of the meaning of family.

*Moderator:*

**Jennie McLaurin, MD, MPH, FAAP**, Senior Fellow, Public Health Integration and Innovation, NACHC

*Panelists:*

**Noemi Librado-Sanchez**, Documentary Filmmaker

**Esmirna Librado**, Documentary Filmmaker

#### **Closing Remarks**

**Rachel Gonzales-Hanson**, Interim President and CEO, NACHC

1:00pm – 7:00pm

**Sea Mar Community Health Centers Site Visit - Skagit Valley:  
Sea Mar Mount Vernon Medical Clinic and Mobile Clinic**

Off-Site

Following the close of the conference, preregistered attendees will join us for a tour and dialogue with staff of the Sea Mar Community Health Centers Migrant Health Clinic (Mount Vernon, WA), approximately 62 miles from Seattle. We will visit the Sea Mar Mount Vernon Medical Clinic, Mobile Clinic, and the Skagit Valley agricultural area. *(This event is limited to 48 participants and is closed for on-site registration.)*

The tour bus will leave the Grand Hyatt Seattle (7th Avenue side entrance) at approximately 1:00pm and arrive at the health center at 2:30pm for a 2-3 hour site visit and local tour. The bus will return to the hotel at approximately 7:00pm.

# NACHC POPULATION HEALTH DIVISION



## OUR FOCUS AREAS

### SOCIAL DRIVERS OF HEALTH



- Training & Technical Assistance on Assessing & Addressing SDOH
- Stories from the Field on SDOH Innovations
- Working Upstream to Address the Roots of Health Inequities
- PRAPARE®

### ENVIRONMENTAL HEALTH



- Training & Technical Assistance
- NACHC Environmental Health & Climate Change Interest Group
- Patient-Centered Climate Resilience
- Energy Solar Financing Project (CHARGE Partnership)

## CONTACT US!

- **Ben Money** | [bmoney@nachc.org](mailto:bmoney@nachc.org)  
Senior VP, Population Health Division
- **Nālani Tarrant** | [ntarrant@nachc.org](mailto:ntarrant@nachc.org)  
Deputy Director, Social Drivers of Health
- **Jessica Hinshaw** | [jhinshaw@nachc.org](mailto:jhinshaw@nachc.org)  
Program Manager, Environmental Health

**SIGN-UP FOR THE  
SDOH BULLETIN!**



**SIGN-UP FOR THE  
ENVIRONMENTAL  
HEALTH NEWSLETTER!**



*The National Association of Community Health Centers  
recognizes the 2023 Conference for Agricultural Worker Health Planning Committee  
for their commitment of time and service. Thank you.*

**Debra Andree, MD**

Chief Executive Officer, Community Health Centers of Florida

**Mary Bartolo**

Chief Executive Officer, Sea Mar Community Health Centers

**Gina Capra, MPA**

Senior Vice President, Training and Technical Assistance, NACHC

**Margaret Davis, MSW**

Director, Knowledge Management and Learning, NACHC

**Seth Doyle, MA**

Director of Strategic Initiatives, Northwest Regional PCA

**Monica Garcia, MA**

Health Strategy Specialist, MHP Salud

**Lisette Garrity, CMP**

Director, Meeting Logistics and Housing, NACHC

**Patricia Gepert**

Health Access Senior Coordinator, Washington PCA

**Alicia Gonzales, MSSW**

Chief Operating Officer, National Center for Farmworker Health

**Rachel Gonzales-Hanson**

Interim President and CEO, NACHC

**Mel Goodwin-Hurley, JD**

Grants/Contracts Officer and General Counsel, North Carolina Community Health Center Association

**Alexis Guild, MPP**

Vice President, Strategy and Programs, Farmworker Justice

**Latisha Harley, MPA, PMP**

Manager, Business Process and Special Projects, NACHC

**Rhonda Hauff**

Chief Executive Officer, Yakima Neighborhood Health

**Emily Heard, MA**

Director, Health Center Governance Training, NACHC

**Jessica Hinshaw, MPH**

Program Manager, Public Health Priorities, NACHC

**Jillian Hopewell, MPA, MA**

Chief Program Officer, Education and Communication, Migrant Clinicians Network

**Julie Hulstein, MNM**

Executive Director, CHAMPS (Region 8 PCA)

**Ethan Kerns, DDS**

Chief Dental Officer, Salud Family Health Care

**Sonia Lee, MPH**

Program Director, Client Services and Grants, Health Outreach Partners

**Theresa Lyons-Clampitt**

Senior Programs Manager, Training and Technical Assistance, Migrant Clinicians Network

**Jeremy McClain**

Legal Research Analyst, NACHC

**Jennie McLaurin, MD, MPH, MA**

Senior Fellow, Public Health Integration and Innovation, NACHC

**Marilynne Mikulich**

Director, Special Events and Projects, NACHC

**Mark Millan, MSHA**

Chief Operations Officer, Virginia Garcia Memorial Health Center

**Jason Patnosh**

Associate Vice President, Development and Innovation, NACHC

**Sarah Rittner, MA**

NACHC Contractor, SASU Project Management

**Jessica Sanchez, MSN**

Vice President, Quality and Operations, Colorado Community Health Network

**Helene Slavin, DES**

Specialist, Meetings and Event Technology, NACHC

**Nalani Tarrant, MPH, PMP**

Deputy Director, Social Drivers of Health, NACHC

**Jennifer Turner**

Manager, Grassroots Communications and Engagement, NACHC

**Taylor Walker**

Specialist, Conference and Event Operations, NACHC

**Jason Watkins, CMP**

Associate Vice President, Conferences and Exhibits, NACHC

**Mary Ann Zelazny, MBA**

Chief Executive Officer, Finger Lakes Community Health and Region 2 Representative, NACHC Board of Directors

## Need Help?

We want to ensure that your attendance at this conference is an enjoyable experience.

If we can be of any assistance, please call on any member of the Meetings Team.

**Mary Hawbecker, CPA**

Senior Vice President, Operations and Chief Financial Officer

**Lisette Garrity, CMP**

Director  
Meetings Logistics and Housing

**Laura Headrick**

Manager  
Exhibits and Sponsorships

**Helene Slavin, DES**

Specialist  
Meetings and Event Technology

**Taylor Walker**

Specialist  
Events and Conference Operations



# Key to Moderators and Presenters

Anna, Erika - ATuB1  
Atencio, Marisa - AWA1

Berschauer, Sheila - AGS2  
Blanco, Jesus - ATuA1  
Bowers, Tonya - AGS2  
Bruno, Jack - AWB1  
Burton, Susan - ATuA1

Caballero, Stefanny - ATuA2  
Carrillo, Gladys - AWA1, AWB2  
Chavez, Claudia - ATuB3  
Contreras, Lizette - ATuB3  
Cuesta, Guadalupe - AWB3

de la Cruz, Yuriko - AWB2  
Dhaliwal, Nancy - ATuB3  
Doyle, Seth - ATuB3

Espinoza, Celina - AWA1

Garcia, Sirene - AWB3  
Gonzales, Alicia - ATuA3  
Gonzales-Hanson, Rachel - AGS1,  
AGS3

Gray, Bruce - AGS2  
Guild, Alexis - AGS2, AWB1, AWB2,  
AWB3

Guillen, Rosalinda - AGS3

Halpin, Sarah - ATuB1  
Harris, Emily - AWA2  
Hauff, Rhonda - AGS1  
Hernandez, Paloma - Luncheon,  
AGS2

Hinshaw, Jessica - AGS3  
Holmes, Michael A. - AGS1,  
Luncheon  
Hopewell, Jillian - AWB3, AGS3

Iniguez, Uriel - AGS2

Jolly, Gerrard - AWA1  
Josway, Elena - AWB2

Keuroghlian, Alex - AWB1  
Kinsey, William - ATuB1

Librado, Esmirna - AGS3  
Librado-Sanchez, Noemi - AGS3

Marsalli, Bob - AGS1  
Martinez, Yadira - ATuB2  
McLaurin, Jennie - Luncheon,  
AGS3  
Meraz, Maria - ATuB3  
Miller, Lisa - ATuA3, AGS3

Navarro, Manuel - AGS1  
Negrete, Dulce - AGS1  
Nolon, Anne Kauffman - AWA1

Oxford, Sandra - AWA1

Patnosh, Jason - ATuA2  
Polkey, Faith - ATuA2, AWA3

Rodriguez-Diaz, Carlos - AWB1  
Roggiero, Jean Paul - AWA2  
Ruivivar, Lindsey - ATuB2

Salazar, Deb - ATuA3  
Santistevan, John - Luncheon  
Sears, Abby - AGS1  
Sobel, Danielle - ATuB2  
Sweeney, Desiree - ATuB2

Tijerina, Jesus - ATuA3  
Trevino-Sauceda, Mily - AWB2

Valentin, Mari - AWA2  
Volkman, Kelly - ATuB3

Walker, Rachele - AWA2  
Wang, Grace - AWA3  
Weaver, Donald - ATuB2  
Weinman, Steve - Luncheon  
Williams, Gervean - ATuA2  
Woodard, Lathran J. - Luncheon  
Woolley, Martine - ATuB2

Ybarra-Vega, Mary Jo - AGS3  
Yee, Ronald - AGS3

Zelazny, Mary - AWB3



## Elevate Learning Forum

Registration  
IS FREE!

Elevate is a national community of health centers and partners coming together to transform systems and enhance value. Elevate offers a collaborative environment for sharing experiences and learning organized by the Value Transformation Framework (VTF).

Value is defined as the Quintuple Aim: improved health outcomes, improved patient experiences, improved staff experiences, reduced costs, and equity.

### Guided application of the Value Transformation Framework

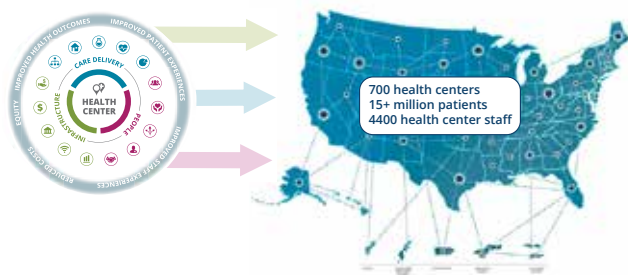

Health centers coming together to engage in systems change through application of the Value Transformation Framework

### WHY participate in Elevate?

- FREE access to transformation tools
- Save time with 'bite-size' actionable, resources
- Resources tailored to roles across your organization
- Connect with peers across the nation
- Improve measures of performance+
- Explore new ways of working and delivering care
- Enrich patient and staff experience
- Build/enhance care management programs

Register at [bit.ly/2023Elevate](https://bit.ly/2023Elevate)



# Ad Index

2023 Community Health Institute (CHI) & EXPO . . . . . Back Cover

Centene Corporation . . . . . 4

Community Health Ventures . . . . . 19

Elevate Learning Forum. . . . . 30

Forvis . . . . . 7

McKesson . . . . . 10

Molina Healthcare.. . . . 25

NACHC Career & Leadership Coaching Services . . . . . 31

NACHC Governance Resources. . . . . 39

NACHC Health Center Advocacy Network . . . . . 39

NACHC Membership . . . . . Inside Front Cover

NACHC Population Health Division . . . . . 28

Nonstop Wellness . . . . . 17

Scribe-X and MyTeam. . . . . 37

The MEDCOR GROUP, Inc. . . . . 12

Workforce Summitt . . . . . 21



## Career & Leadership Coaching Services



**INCREASE EMPLOYEE RETENTION**



**BUILD LEADERSHIP BENCH STRENGTH**



**IMPROVE PRODUCTIVITY**



**INCREASE LEARNING RETENTION**

**INDIVIDUAL & TEAM OPTIONS  
REGISTER ANY TIME!**

**SCAN FOR MORE INFORMATION**





The National Association of Community Health Centers  
would like to thank the following  
2023 Conference for Agricultural Worker Health Sponsors  
for their support:



2023 Leader Sponsors



Partner Sponsors



Silver Sponsor



Vendor Collective Sponsors



Bronze Sponsors





# Sponsor Profiles

## National Association of Community Health Centers

The National Association of Community Health Centers (NACHC) is the leading membership organization representing the nation's network of community-based health centers. Through NACHC, health centers have direct access to benefits and services tailored specifically to their needs and unique environments. Stop by our table to learn more about NACHC and discover some of our new and exciting benefits, products, programs, and services.

Keisha Mukanos, 7501 Wisconsin Avenue, Suite 1100W, Bethesda, MD 20814

Phone: (301) 347-0400 Email: [membership@nachc.org](mailto:membership@nachc.org)

[www.nachc.org](http://www.nachc.org)



### Leader Sponsors

## Centene Corporation

Centene Corporation is committed to helping people lead healthier lives through its longstanding partnership with the National Association of Community Health Centers (NACHC). As a Fortune 50 healthcare company that's grown to serve more than 27 million members, our local approach enables us to provide accessible, high-quality, culturally sensitive services to members in all 50 states. Every individual, family, and community we serve is unique.

Ralph Perez, 7700 Forsyth Boulevard, St. Louis, MO 63105

Phone: (314) 604-6893 Email: [rperez@centene.com](mailto:rperez@centene.com)

[www.centene.com](http://www.centene.com)



## Community Health Ventures

Community Health Ventures (CHV) is the business development affiliate of the National Association of Community Health Centers (NACHC). Founded in 2000 under the direction of health center leadership, CHV creates solutions to the economic pressures facing health centers. By negotiating group-purchasing agreements for medical supplies and office supplies, insurance, staffing solutions, lab agreements and much more, CHV helps health centers reduce costs. CHV is proud to partner with best in class distributors, manufacturers, and suppliers while offering discounted rates to health centers.

Brittney Reilly, 211 N. Union Street, Alexandria, VA 22314

Phone: (732) 740-9641 Email: [breilly@nachc.com](mailto:breilly@nachc.com)

[www.communityhealthventures.com](http://www.communityhealthventures.com)



## FORVIS

You have big plans for your CHC, but navigating the industry's constant changes is no easy feat. FORVIS has been a leading educator for NACHC and PCAs for more than five years and is authoring NACHC's forthcoming financial manual for America's health centers. We can help you prepare for potential changes to grants, payor mix, reimbursement, and the 340B Drug Pricing Program.

Jenalee Davidson, 910 E. St. Louis Street, Springfield, MO 65802

Phone: (417) 241-9615 Email: [jenalee.davidson@forvis.com](mailto:jenalee.davidson@forvis.com)

<http://forvis.com/chc>



## McKesson Medical Surgical

McKesson Medical Surgical is pleased to continue our support this year. Bringing you more than 350,000 products you need, when you need them. We offer tools that help you manage costs and enhance patient care - all while providing insights and expertise to guide you through the changing world of healthcare. We deliver the right products and the right solutions to address today's challenges, while preparing for tomorrow.

Danny Bado, 9954 Mayland Drive, Suite 4000, Richmond, VA 23233

Phone: (209) 628-2058 Email: [danny.bado@mckesson.com](mailto:danny.bado@mckesson.com)

<http://mms.mckesson.com>

**MCKESSON**



### Partner Sponsors

## Mission Mobile Medical

Mobile Clinics are critical to the healthcare fight. Real People, all across America, aren't being served effectively by our healthcare system. Mobile Clinics improve health equity and lower system-wide healthcare costs, and help our most vulnerable neighbors. The biggest hurdle for healthcare leaders unlocking the potential of mobile clinics is the time and complexity of standing up a new mobile clinic program. The team at Mission Mobile Medical decided to fix it. We now provide mobile clinics and contract services to FQHCs and other provider partners to allow them to make healthcare more accessible and more equitable. Today, taking care of your community is easier, faster, and more impactful than ever before. That's why we're here. And we're glad you're here with us.

Monica Grashuis, 450 Sinclair Street, Reno, NV 89501

Phone: (775) 415-8989 Email: [mgrashuis@missionmobilemed.com](mailto:mgrashuis@missionmobilemed.com)

[www.missionmobilemed.com](http://www.missionmobilemed.com)



## Mutual of America

Mutual of America Financial Group provides retirement plan services nationwide. We are the trusted service provider for many nonprofit and FQHC organizations. For nearly 80 years, our proven approach to simplifying retirement planning and investing has helped plan participants prepare for their retirement endeavors.

Jason Hurst, 320 Park Avenue, New York, NY 10022

Phone: (629) 800-6621 Email: [Jason.Hurst@mutualofamerica.com](mailto:Jason.Hurst@mutualofamerica.com)

[www.mutualofamerica.com](http://www.mutualofamerica.com)



## OSIS

OSIS provides expert NextGen® Healthcare technology assistance to community health centers around the country through innovative solutions, data analytics, Quality Improvement, and consulting services that enhance clinical outcomes. Representing NextGen's largest network of community health centers, our fundamental premise is to share expertise, best practices, and resources for a holistic approach to value-based care.

Nicole Miller, 8790 Governor's Hill Drive, Cincinnati, OH 45249

Phone: (513) 707-1658 Email: [Nicole.miller@osisonline.net](mailto:Nicole.miller@osisonline.net)

[www.osisonline.net](http://www.osisonline.net)



## Silver Sponsor

### Molina Healthcare

Molina Healthcare was founded in 1980 by Dr. C. David Molina, an emergency room physician with a mission to provide quality health care to those who needed it, no matter the circumstances. Molina Healthcare of Washington has been caring for individuals and families across the state of Washington for over 22 years. Today, Molina Healthcare of Washington serves over 1 million members through government-sponsored programs – Apple Health (Medicaid), Medicare, and the Health Benefit Exchange in every county across Washington state. We collaborate with community partners to eliminate access barriers and tackle health disparities to improve the health and lives of our members and communities. Every day, Molina works to earn the continued trust of our members, providers, and community partners, so they can lean on us.



Sonia Morales, 21540 30th Street SE, Suite 100, Bothell, WA 98021

Phone: (425) 393-5501 Email: [sonia.morales@molinahealthcare.com](mailto:sonia.morales@molinahealthcare.com)

[www.molinahealthcare.com](http://www.molinahealthcare.com)

## Vendor Collective Sponsors

The *Vendor Collective* is a small group of companies that are committed in their effort to serve migrant and community health centers and show their support for the Ag Worker Access Campaign. They believe that health centers can substantially increase access to quality care for this special population through the power of collaboration, meaningful partnership, and technology. Their goal is to share innovative business solutions that can make a difference to the work of health centers, ultimately creating a positive impact on the health and well-being of agricultural workers nationwide.

### Medcor Group, Inc.

Medcor provides a full range of medical billing services for FQHCs across the country. Our team of FQHC billing experts is here to ensure our clients receive the maximum allowable reimbursement for services rendered. We are proud that all of our work is performed in the United States. Widely recognized as one of the nation's top FQHC revenue cycle companies, we bring years of experience as well as a deep understanding of the unique world of FQHC reimbursement. Using state-of-the-art EMR/EHR or CCHIT-certified medical billing platforms, we provide our clients with live metric-driven reports and dashboards to show progress and allow for future planning. We believe that more money means more mission and it is our goal to help our FQHC clients thrive.



Jason Gerber, 725 W. Town and Country Road, Suite 300, Orange, CA 92868

Phone: (714) 221-8512 Email: [jason@medcorinc.com](mailto:jason@medcorinc.com)

[www.medcorinc.com](http://www.medcorinc.com)

### Nonstop Administration and Insurance Services, Inc.

Nonstop Administration and Insurance Services, Inc. is a proud participant in the Value in Benefits (ViB) program from Community Health Ventures (CHV), the business affiliate of the National Association of Community Health Centers (NACHC). Nonstop is changing the way health centers and their employees access healthcare with their proprietary employer-sponsored health insurance program: Nonstop Health. The Nonstop Health program uses first-dollar coverage and innovative plan design to decrease the annual costs of employee health insurance for community health centers (CHCs) while reducing or eliminating copays, deductibles, and coinsurance. Nonstop's mission is to ensure the growth and sustainability of the Community Health Center Movement – starting with the health and well-being of their employees.



Jody Schreffler, 1800 Sutter Street, Suite 730, Concord, CA 94520

Phone: (503) 260-5634 Email: [jschreffler@nonstophealth.com](mailto:jschreffler@nonstophealth.com)

[www.nonstophealth.com](http://www.nonstophealth.com)

## Scribe-X and MyTeam Medical Staffing Services

Scribe-X and MyTeam empower health centers to ease provider burden and staff their teams to increase provider and patient satisfaction. Scribe-X offers Remote Medical Scribe programs with quality metric-driven training geared to support the health center and its providers' needs, goals, and preferences. Going far beyond the capabilities of other documentation solutions, Scribe-X Remote Medical Scribes deliver real-time documentation, by US-based scribes, directly into your EHR while using our telehealth platform, ScribeBridge™. Scribe-X Medical Scribes allow providers to save time, become more productive, and focus on the quality of care while maximizing clinical documentation for optimal quality metric tracking and reimbursement. MyTeam's comprehensive medical staffing expertise and widely connected network, in the healthcare field, help find the right fit the first time to meet your health center's staffing needs.



**Ethan Palioca, 931 SW King Avenue, Portland, OR 97205**  
Phone: (503) 914-5857      Email: [ethan@scribe-x.com](mailto:ethan@scribe-x.com)  
[www.scribe-x.com](http://www.scribe-x.com)

## Bronze Sponsors

### ACSI

Allied Customer Solutions, Inc. (ACSI) is a nearshore call center that specializes in the FQHC industry. We have been serving the call center and receivables management industries in the United States for over 25 years, with headquarters in Las Vegas, Nevada. ACSI offers high-quality services like Patient Scheduling, Prescription Refills, Medical Records, Enrollment Support, Revenue Cycle, and Referral Department. Our expansion of our facility in Tijuana, Mexico provides us with numerous advantages, resulting in significant savings for our clients who choose to take advantage of the opportunity. Our goal is to alleviate your staffing needs with quality talent and deliver measurable results.



**Elisabet Rodriguez, 3090 Durango Drive, Las Vegas, NV 89117**  
Phone: (702) 939-8349      Email: [elisabet@goacsi.com](mailto:elisabet@goacsi.com)  
<http://goacsi.com>

### Association of Diabetes Care & Education Specialists

The Association of Diabetes Care & Education Specialists (ADCES) is an interdisciplinary professional membership organization dedicated to improving prediabetes, diabetes, and cardiometabolic care through innovative education, management, and support. As a community of collaborators, advisors and supporters, the organization translates evidence-based research into accessible resources so members can stay on top of best practices and propel the specialty forward. ADCES offers an integrated care model that lowers the cost of care, improves experiences, and helps its members lead to better outcomes.



**Natalie Elleson, 125 S. Wacker Drive, Suite 600, Chicago, IL 60606**  
Phone: (312) 601-4857      Email: [nelleson@adces.org](mailto:nelleson@adces.org)  
[www.diabeteseducator.org](http://www.diabeteseducator.org)

### National Center for Farmworker Health

The National Center for Farmworker Health, Inc. (NCFH) is a private, not-for-profit corporation, located in Buda, Texas, dedicated to improving the health status of agricultural worker families by providing information services, training and technical assistance, and a variety of products to community and migrant health centers nationwide, as well as organizations, universities, researchers, and individuals involved in Ag Worker Health.



**Chelsea Brown, 1770 FM 967, Buda, TX 78610**  
Phone: (521) 312-5470      Email: [brown@ncfh.org](mailto:brown@ncfh.org)  
[www.ncfh.org](http://www.ncfh.org)



## PERC-med (University of California Davis)

PERC-med helps medical professionals prevent, recognize, and treat pesticide-related illness. PERC-med is the Pesticide Educational Resources Collaborative for Medical Professionals, a five-year cooperative agreement between the EPA's Office of Pesticide Programs and University of California Davis in collaboration with Oregon State University. We provide pesticide-specific resources, training, technical assistance, and collaborative opportunities in partnership with healthcare providers.



Diana Simmes, 463 California Avenue, International Center Building, Suite 1130, Davis, CA 95616

Phone: (760) 815-2633 Email: [drsimmes@ucdavis.edu](mailto:drsimmes@ucdavis.edu)

<https://pesticideresources.org/med>

## Pfizer

At Pfizer, we apply science and our global resources to bring therapies to people that extend and significantly improve their lives. We strive to set the standard for quality, safety, and value in the discovery, development, and manufacture of health care products. Our global portfolio includes medicines and vaccines as well as many of the world's best-known consumer health care products. Every day, Pfizer colleagues work across developed and emerging markets to advance wellness, prevention, treatments, and cures that challenge the most feared diseases of our time. Consistent with our responsibility as one of the world's premier innovative biopharmaceutical companies, we collaborate with health care providers, governments, and local communities to support and expand access to reliable, affordable health care around the world. For more than 170 years, Pfizer has worked to make a difference for all who rely on us.



Darci Aeder, 235 East 42nd Street, New York, NY 10017

Phone: (360) 790-7989 Email: [darci.k.simons@pfizer.com](mailto:darci.k.simons@pfizer.com)

[www.pfizer.com](http://www.pfizer.com)



WE PROVIDE  
POWERFUL TOOLS THAT

Produce Powerful  
Results

Scribe-X and MyTeam Medical Staffing Solutions empower you to support providers and improve patient care by reducing burnout and staffing shortages while creating new revenue streams for stronger fiscal health. **VISIT US AT [SCRIBE-X.COM](http://SCRIBE-X.COM) OR [MYTEAMMEDICALSTAFFING.COM](http://MYTEAMMEDICALSTAFFING.COM)**



WE LOOK FORWARD TO MEETING YOU AT THE 2023 NACHC CONFERENCE FOR AGRICULTURAL WORKER HEALTH

## The Inline Group

From primary care physicians, to specialists, and nurses, it takes top talent to keep health centers up and running at peak. Partner with The Inline Group for access to the providers you need to take the lead on better outcomes in health and business. For over 15 years, FQHCs have used our Essential platform, which provides unlimited hiring with zero placement fees.

Joseph Valdez, 4100 Midway Road, Suite 1060, Carrollton, TX 75007

Phone: (214) 260-3255 Email: [jvaldez@inline.group](mailto:jvaldez@inline.group)

[www.inline.group](http://www.inline.group)



## TruMed Systems

TruMed is the fastest growing vaccine storage and handling company providing inventory management solutions to individual clinics, major health systems, and public healthcare facilities throughout the US. AccuVax is the only vaccine storage and management system that automates vaccine control and integrity, minimizes risks of incorrect vaccine delivery, and optimizes office workflow. The AccuShelf inventory management system expands TruMed's inventory management tools to track medications, supplies, and more throughout a healthcare setting. All products by TruMed include hardware, software, online reports, software updates, training, optional EHR integrations, 24/7 support and maintenance, and industry-leading security. Schedule a demo at [AccuVax.com](http://AccuVax.com), 844-878-6331, or [info@AccuVax.com](mailto:info@AccuVax.com).

Michael DeSantis, 4370 La Jolla Village Drive, Suite 200, San Diego, CA 92122

Phone: (844) 878-6331 Email: [tradeshows@trumedsystems.com](mailto:tradeshows@trumedsystems.com)

<https://trumedsystems.com>



## UnitedHealthcare

UnitedHealthcare offers a full range of health benefits, enabling affordable coverage, simplifying the health care experience and delivering access to high-quality care.

Melanie Garnica, 17930 International Boulevard, Suite 1000, Sea Tac, WA 98188

Phone: (253) 254-2935 Email: [melanie\\_garnica@uhc.com](mailto:melanie_garnica@uhc.com)

[www.uhccp.com/washington](http://www.uhccp.com/washington)



## Washington State Department of Labor & Industries

The Department of Labor & Industries (L&I) is a diverse state agency dedicated to the safety, health, and security of Washington's 3.3 million workers. We help employers meet safety and health standards, and we inspect workplaces when alerted to hazards. As administrators of the state's workers' compensation system, we are similar to a large insurance company, providing medical and limited wage-replacement coverage to workers who suffer job-related injuries and illness. Our rules and enforcement programs also help ensure workers are paid what they are owed, that children's and teens' work hours are limited, and that consumers are protected from unsound building practices. We serve customers in 19 offices throughout Washington and have approximately 2,800 skilled employees, including safety inspectors, claims specialists, nurses, researchers, accountants, labor experts, and support staff.

Carmen Rivera, 7273 Linderson Way SW, Tumater, WA 98501

Phone: (360) 333-0362 Email: [carmen.rivera@lni.wa.gov](mailto:carmen.rivera@lni.wa.gov)

[www.lni.wa.gov](http://www.lni.wa.gov)



# Health Center Governance Resources

NACHC has over **50** resources to support health center boards!



## Governance Fundamentals, Short Videos, E-Learning Modules & more including many resources in Spanish!

- Governance Guide for Health Center Boards
- Health Center Board Roles – Video
- Customizable Board Member Orientation Template\*
- Modules on Board Financial Oversight
- Sliding Fee Discount Program - Videos
- Boards and Workforce Issues

Find resources on the Health Center Resource Clearinghouse, Governance “Quick Finds” page at <https://www.healthcenterinfo.org/quick-finds-governance/> or

NACHC’s Health Center Governance page at

<https://www.nachc.org/trainings-and-conferences/governance/>.



*This resource was supported by the Health Resources and Services Administration (HRSA) of the U.S. Department of Health and Human Services (HHS) as part of an award totaling \$6,719,834 with 0% percentage financed with non-governmental sources. The contents are those of the author(s) and do not necessarily represent the official views of, nor an endorsement, by HRSA, HHS, or the U.S. Government. For more information, please visit HRSA.gov.*

*\*Indicates a resource not funded by HRSA*

**Health Center Leadership:**  
Channeling the Wisdom of the Migrant Worker Movement

**EQUIPPING**  
people with the

**POWER**  
to create

**CHANGE**

Become an **ADVOCATE**

NATIONAL ASSOCIATION OF Community Health Centers  
HEALTH CENTER **ADVOCACY NETWORK**

# Upcoming NACHC Conferences and Trainings

**MARK YOUR CALENDARS!**

**Check back regularly to see which events will include virtual streaming!**

*(as of April 6, 2023 and subject to change)*

The National Association of Community Health Centers (NACHC) offers a wide variety of online and regional education trainings that encompass all facets of health center operations. Whether you need a refresher or are just starting out in a health center, NACHC offers trainings that will help you become more effective. Below is a partial list of upcoming trainings and conferences provided by NACHC.

DATES	CONFERENCE/TRAINING	HOTEL	CITY
June 13-14, 2023	Elevating Health Center Operations (EHCO)	Virtual	
June 21-22, 2023	Revenue Cycle 360° (Rev Cycle) Hybrid	Caesars Palace Las Vegas	Las Vegas, NV
August 27-29, 2023	Community Health Institute (CHI) & EXPO Committee Meetings: August 25-26, 2023	Manchester Grand Hyatt	San Diego, CA
October 24-25, 2023	Financial, Operations Management/Information Technology (FOM/IT) Conference & EXPO Preconference Workshops: October 23	Paris Las Vegas	Las Vegas, NV
November 13-15, 2023	PCA & HCCN Conference	Omni Louisville Hotel	Louisville, KY
February 12-15, 2024	Policy & Issues Forum (P&I) Committee Meetings: February 10-11, 2024	Marriott Marquis	Washington, DC
August 25-27, 2024	Community Health Institute (CHI) & EXPO Committee Meetings: August 23-24, 2024	Hyatt Regency Orlando	Orlando, FL
February 5-8, 2025	Policy & Issues Forum (P&I) Committee Meetings: February 3-4, 2025	Marriott Marquis	Washington, DC
August 17-19, 2025	Community Health Institute (CHI) & EXPO Committee Meetings: August 15-16, 2025	Hyatt Regency Chicago	Chicago, IL
August 30- September 1, 2026	Community Health Institute (CHI) & EXPO Committee Meetings: August 28-29, 2026	Manchester Grand Hyatt	San Diego, CA

To register for these and future trainings, visit us at <http://nachc.org/trainings-and-conferences/>.

For additional information on NACHC Training, contact  
[trainings@nachc.com](mailto:trainings@nachc.com) or [meetings@nachc.com](mailto:meetings@nachc.com).

This program is supported by the Health Resources and Services Administration (HRSA), of the U.S. Department of Health and Human Services (HHS), as part of an award totaling \$6,719,843. The contents are those of the author(s) and do not necessarily represent the official views of, nor an endorsement by, HRSA, HHS, or the U.S. Government. For more information, please visit [HRSA.gov](http://HRSA.gov).

# Grand Hyatt Seattle

## First Floor/Lobby Level

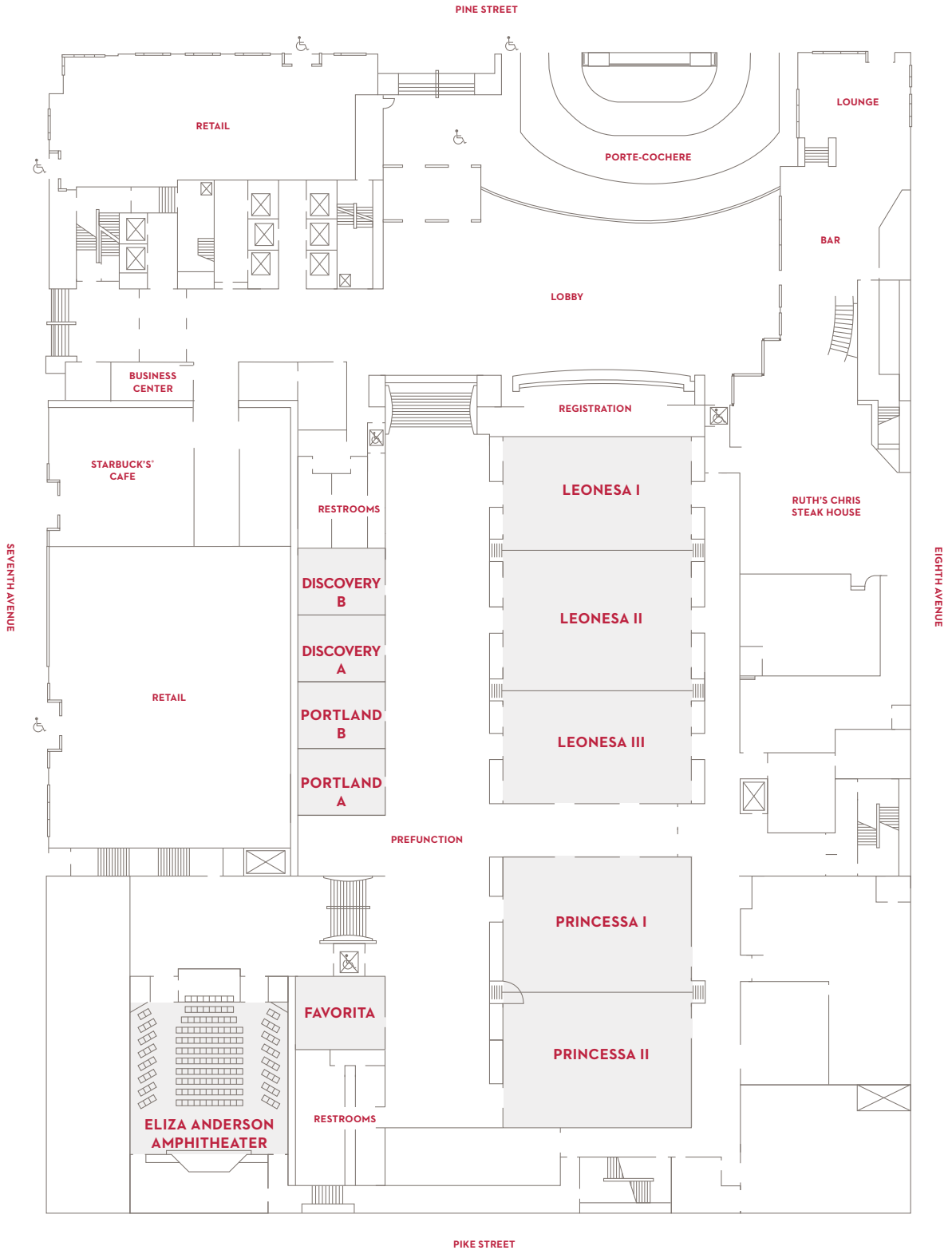



20

COMMUNITY  
HEALTH INSTITUTE

23

# CHI & EXPO

Manchester Grand Hyatt, San Diego, CA  
Conference: August 27-29 | Committee Meetings: August 25-26  
HYBRID

